

**PLEASE POST AND  
DISTRIBUTE**

## Winter Parking and Towing Regulations

We consider snow removal and management to be one of our most serious obligations to you and, as such, we invest considerable time, effort and money in it. Accordingly, Winter Parking and Towing Regulations will be rigidly enforced from November 15 through March 31, regardless of weather conditions. *Failure to follow these regulations will likely result in towing at the vehicle owner's expense.*

As provided in the lease, free on-site parking is provided for employees and visitors of client firms during normal business hours (only). All overnight parking must be approved in advance, and **any vehicle parked between 7:00 PM and 7:00 AM may be towed if it obstructs snow removal operations, unless its driver can be easily located within the building and is immediately available to move the vehicle.**

When a vehicle *must* be left overnight, accommodations can typically be made to do so on the third floor of West Garage. Large vehicles, not fitting in the garage, must be parked in the designated North Lot Snow Parking Area (only). **A temporary permit must be prominently displayed inside the windshield of each overnight vehicle. Permits must be picked up in advance at the leasing office at 100 Cummings Center, Suite 107-L (978-922-9000).**



**Vehicles left in the North Lot Snow Parking Area must be removed each morning to facilitate snow removal operations, and may not be left in said area during normal business hours or on weekends.** Also, please remember that unregistered or disabled vehicles and storage trailers of any type may not be parked anywhere at Cummings Center at any time.

Thank you for your careful cooperation.

REV. 10/2020

**THE OVERNIGHT PARKING AREAS ARE INDICATED BELOW**
**West Garage**

Third floor in the center section only

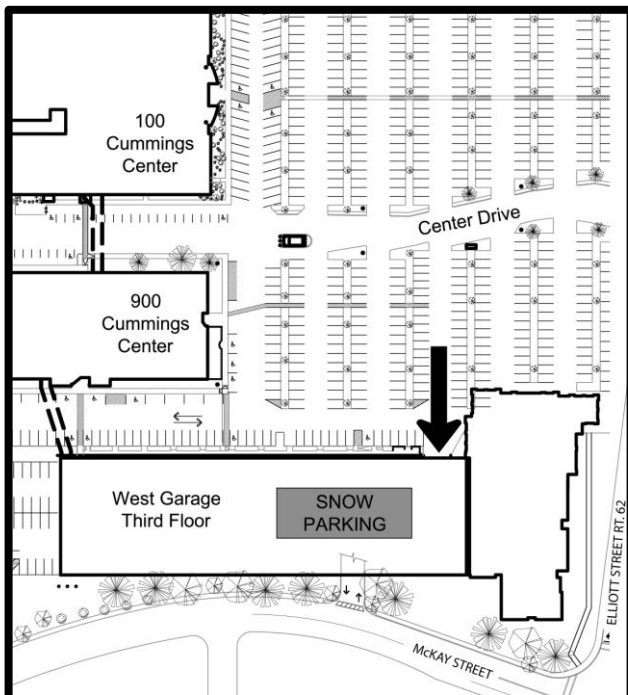
**North Lot Snow Parking Area**

Large vehicles only

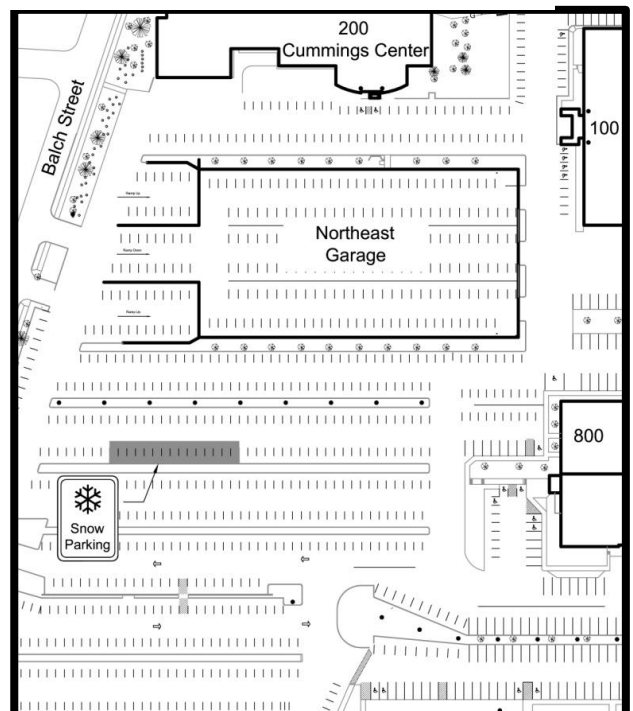

\\CPL-DC\SHARED\SHARED\2\_DOCS\LIBRARY\BEVERLY\LIBRARY PAGE\SNOW PARKING\_BEV.DOCX