

A photograph of a laboratory interior viewed through a glass partition. The lab features several biosafety cabinets with yellow and blue storage units below them. The ceiling is equipped with numerous fluorescent lights, and the floor is a light-colored, polished surface. The text 'Laboratory Offerings' is overlaid at the bottom in a large, white, italicized font.

# *Laboratory Offerings*











Cumming's

# LABS FAST

Available now or build-to-suit





# Join these and other tech/science firms at Cummings Properties:













**Cummings Properties operates its own 342-person year-round staff including all maintenance and construction trades. It also employs full-time locally based leasing managers, architects, engineers, in-house attorneys, etc., to better serve you.**



# Our Iron Butterflies





# All Profits to Nonprofits



Cummings

More than ***\$600 million*** awarded to date  
to Greater Boston-based nonprofits alone.

















# *Energy Efficient Design*





# Emerging Tech Center

at 48 Dunham Ridge

Incubator lab suites from 1,200 SF to 2,000 SF in Beverly





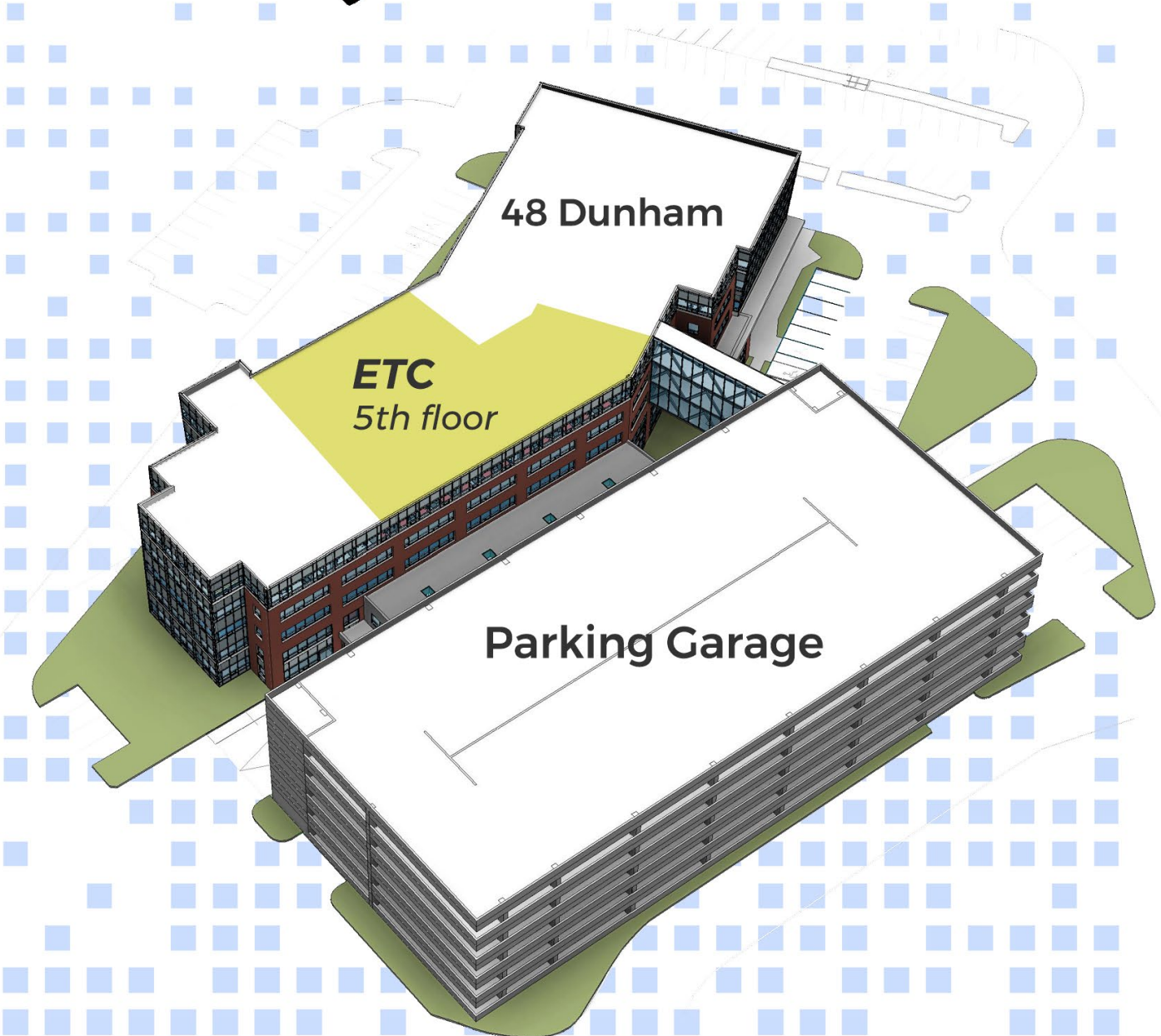
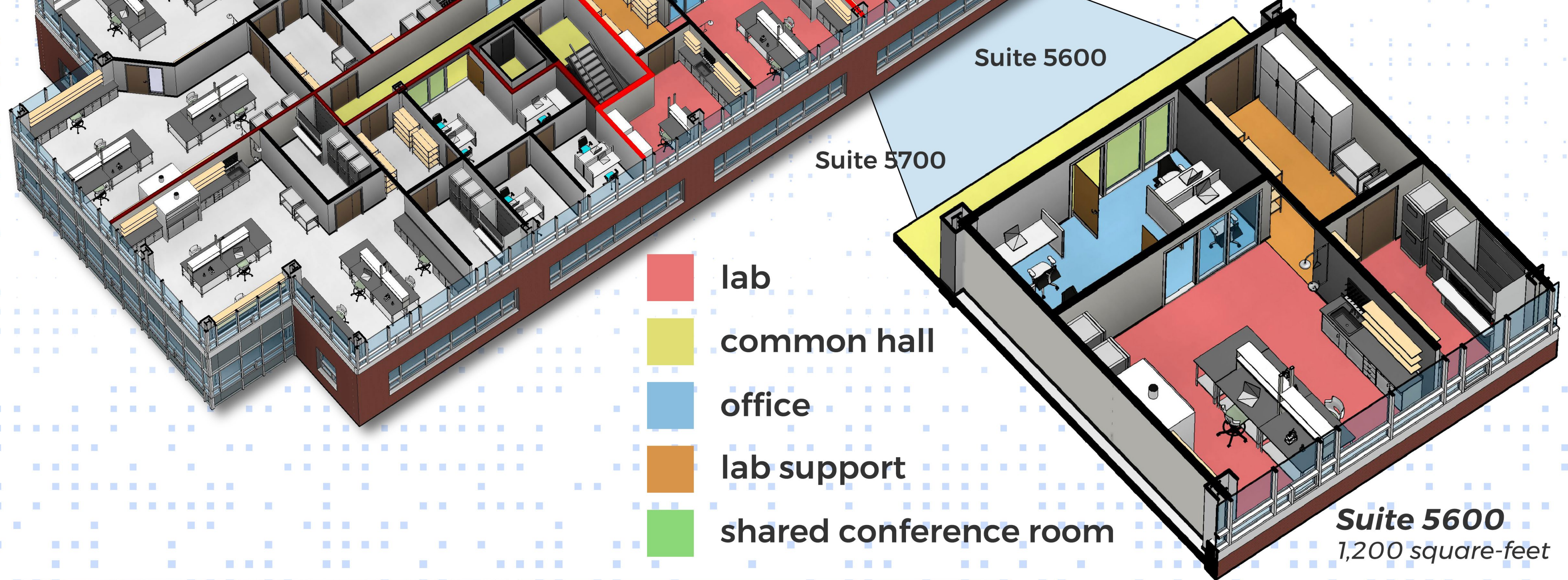

 **Cummins** **DUNHAM** | RIDGE

**Emerging Tech Center**  
at 48 Dunham Ridge

**48** **DUNHAM** | RIDGE







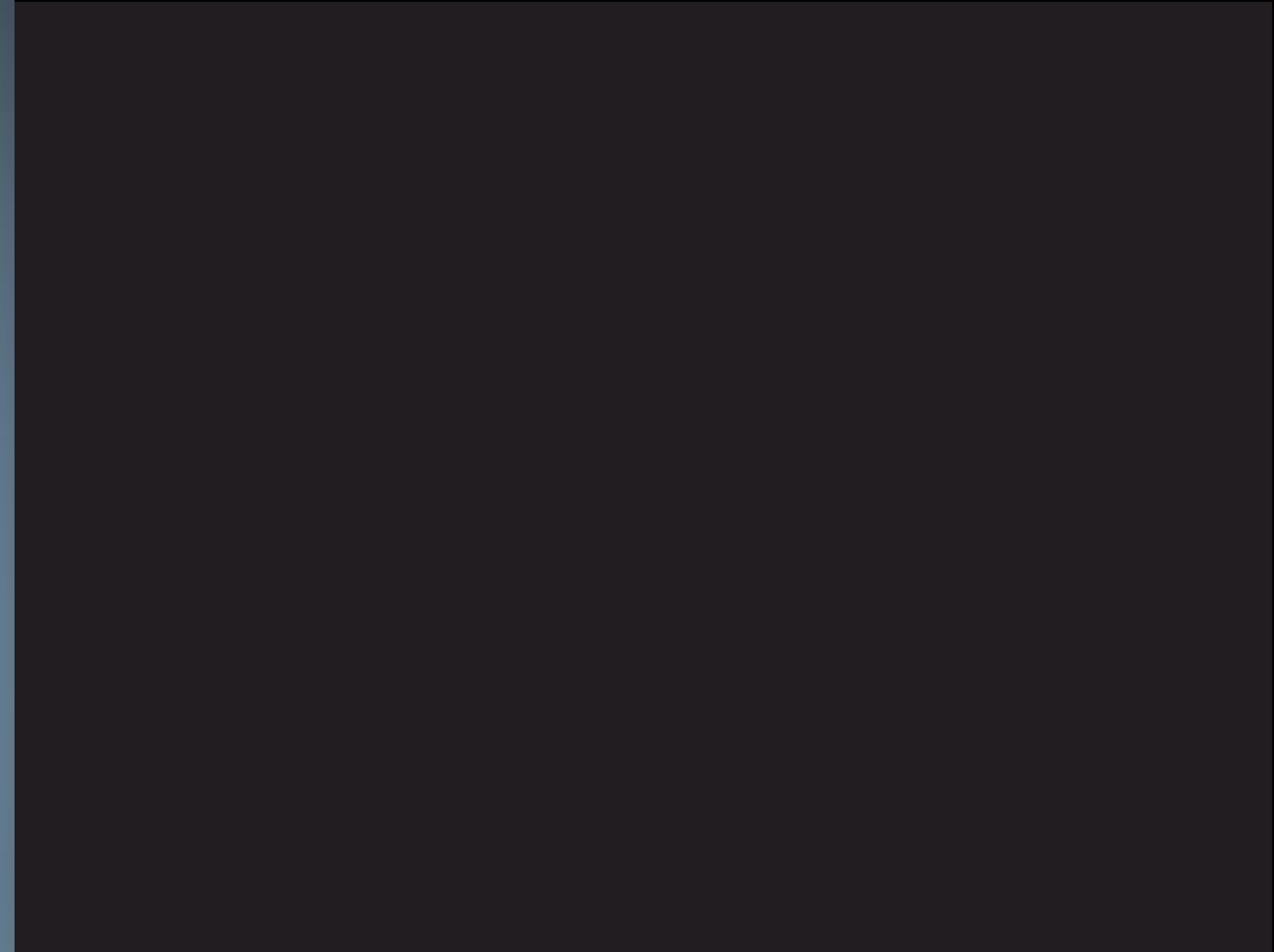























# Service! Service! Service!



## Because you deserve it!



# Life Sciences at Cummings Properties







**Corporate Office:**  
200 West Cummings Park, Woburn, MA • 781-935-8000

**Cummings Center:**  
100 Cummings Center, Beverly, MA • 978-922-9000