

92 Montvale Avenue

Stoneham, Massachusetts

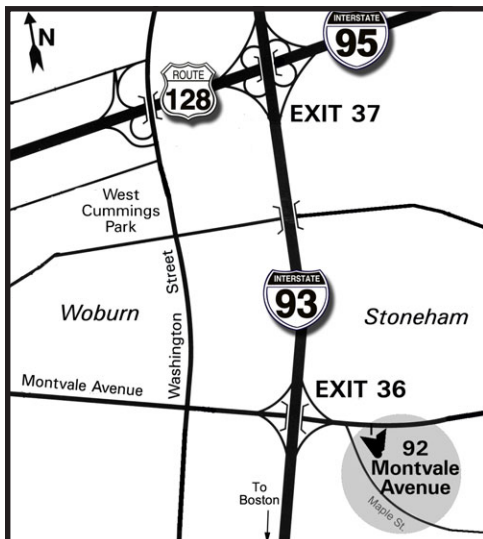

92 Montvale Avenue offers distinctively designed, first-class office facilities with high visibility from Interstate I-93. Superior quality interior finishes and a unique architectural design establish 92 Montvale as an ideal location for corporate headquarters or for any other discriminating office requirement.

Conveniently located less than 10 miles from downtown Boston, 92 Montvale Avenue is immediately accessible to both Interstate 93 and Route 128 (I-95). A variety of local amenities including hotels, restaurants, recreational activities and professional services are all within easy walking distance.

Cummings Properties provides an experienced team of professionals to assure quality building management including leasing, space planning, design, construction and maintenance. With more than 30 years of highly successful development and property management experience, Cummings Properties has a long-standing reputation for service excellence.

Cummings Properties' highly experienced professionals assure quality building management including leasing, space planning, design, construction, and maintenance. Since 1970 this successful development and property management experience has

earned Cummings Properties its long-standing reputation for operational and service excellence.

Call Eric Anderson at 781-932-7038 to schedule an appointment to visit this or any of our other fine properties.

92 Montvale Avenue

Stoneham, Massachusetts

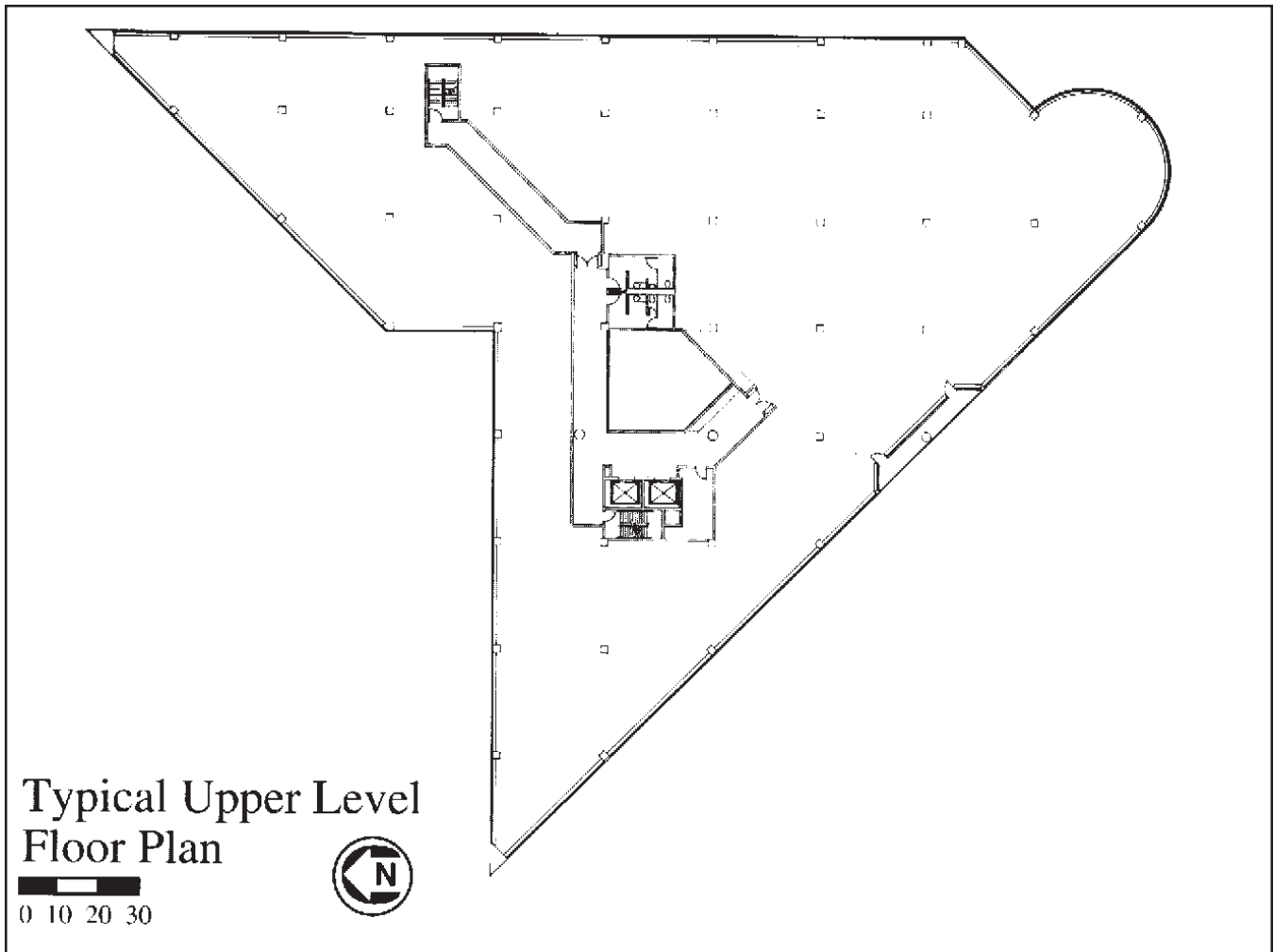

Building Features:

- Skylit 4 story atrium.
- 105,000 SF on 4 floors.
- Suites from 10,000 SF.
- 100 % on-site garage parking.
- High speed Otis elevators.
- State of the art fire protection system.
- 8'-6" ceiling height (typical).
- Fiber-optic telephone service.
- Individual high efficiency HVAC.

Location:

- 8 miles north of Boston.
- 1 mile south of Route 128.
- 14 minutes to Boston's Logan International airport.