

Note: These CAD drawings are recorded on, or can be transmitted as, electronic media. They are therefore subject to undetectable alteration or erasure, either intentional or unintentional, due to, among other causes: transmission, conversion, media degradation, software error, or human alteration. Accordingly, Cummings Properties shall not be held liable for any claims, losses, damages, or costs arising out of any such use of these CAD documents.

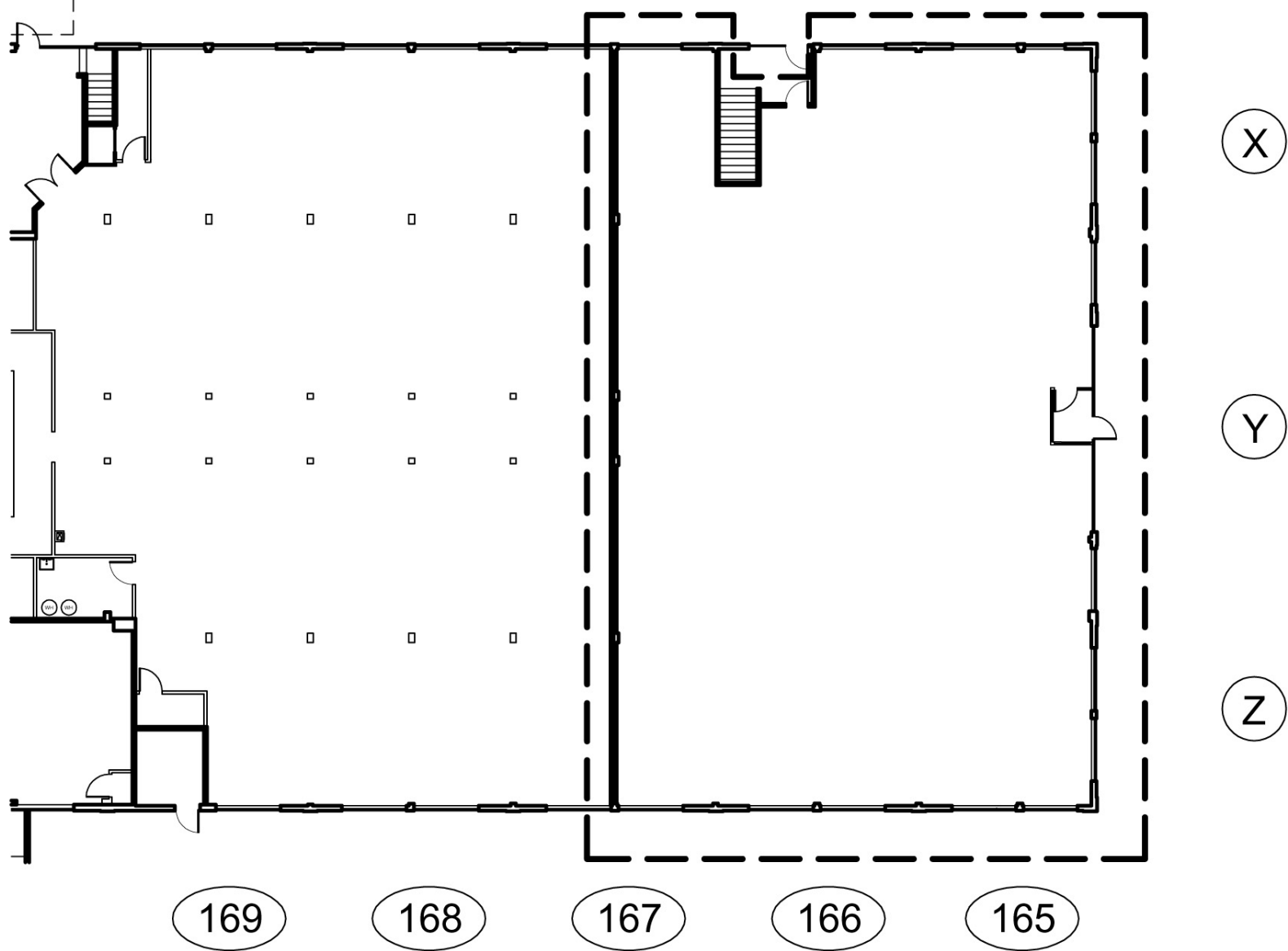

165-Y First Floor -7,430 Isf

600 Cummings Center, Suites 165-Y and 266-X, Beverly, MA



LSF: 20,128±	Scale: * 1"=20'-0"	Date: 03/02/09
Drawn: CB	Checked:	Revised: 03/13/09

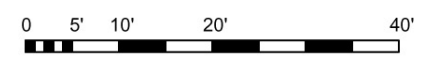

- All dimensions are approximate.
- CPL standard construction unless otherwise noted.
- All finishes to remain as is unless otherwise noted.
- Furnishings are shown for illustrative purposes only.
- No representation is made as to the suitability of this design for lessee's use or occupancy.